

EXIDOR

700 SERIES

HEAVY DUTY HIGH SECURITY
LOCKS, BOLTS & EXIT HARDWARE





Introducing the 700 Series High Security Bolts & Exit Hardware

Exidor Ltd is a UK based engineering company manufacturing a comprehensive, high specification range of innovative panic and emergency exit hardware, and security products.

We've been meeting the needs of architects, specifiers, project managers, OEM's and building managers for more than 60 years. In that time, we've built an unrivalled record of developing and continually enhancing a product range that's known all over the world.

The Exidor 700 series heavy duty high security system combines the requirements of safety and security with the functions of a panic and emergency exit device. The range has been specifically developed to meet the demands required against a physical attack without compromising safety.

The 700 series is British manufactured from high quality steel for strength and rigidity and available in both steel and timber door versions.

All products in the range are manufactured to the highest specifications and, where applicable, have been certified to the European Standards EN1125 for Panic Exit and EN179 for Emergency Exit Devices.

The Exidor 700 series has also been approved to LPS1175 level 6 (Burglary resistance test), Sold Secure Silver Standard and is suitable for high security applications.

Certified to 200,000 uses, the 700 series is available in single, two, three or four point locking, depending on the level of security required, as well as a multi-bolt version for use where emergency exit is not required. Accessories include a choice of outside access devices, locking boxes, high security cylinder escutcheons and heavy duty tower bolts.

All products are available in RAL 7016 finish, stainless steel effect or, where the operating environment is highly corrosive, a solid stainless steel version is available, on request.



What does British manufacturing mean to us?

Understanding what our customers need. Providing local and reliable service. Having a wide range of standard units available from stock for next day delivery. Being able to provide non-standard products. Reacting quickly when it matters. Working to International quality and manufacturing standards and certified to ISO 9001. And caring – professionally – about quality.

Product Selector

Single Doors

Lever Handle Operated

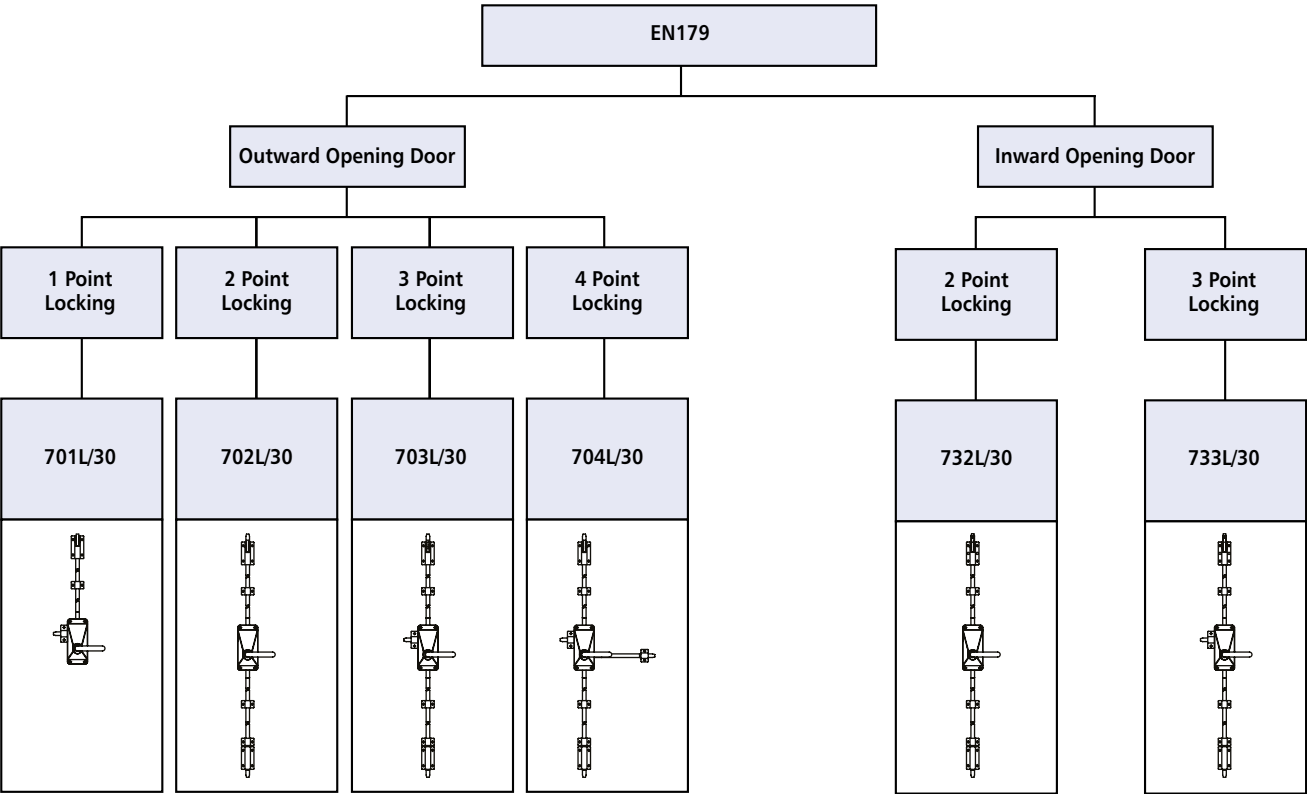

Push Bar Operated

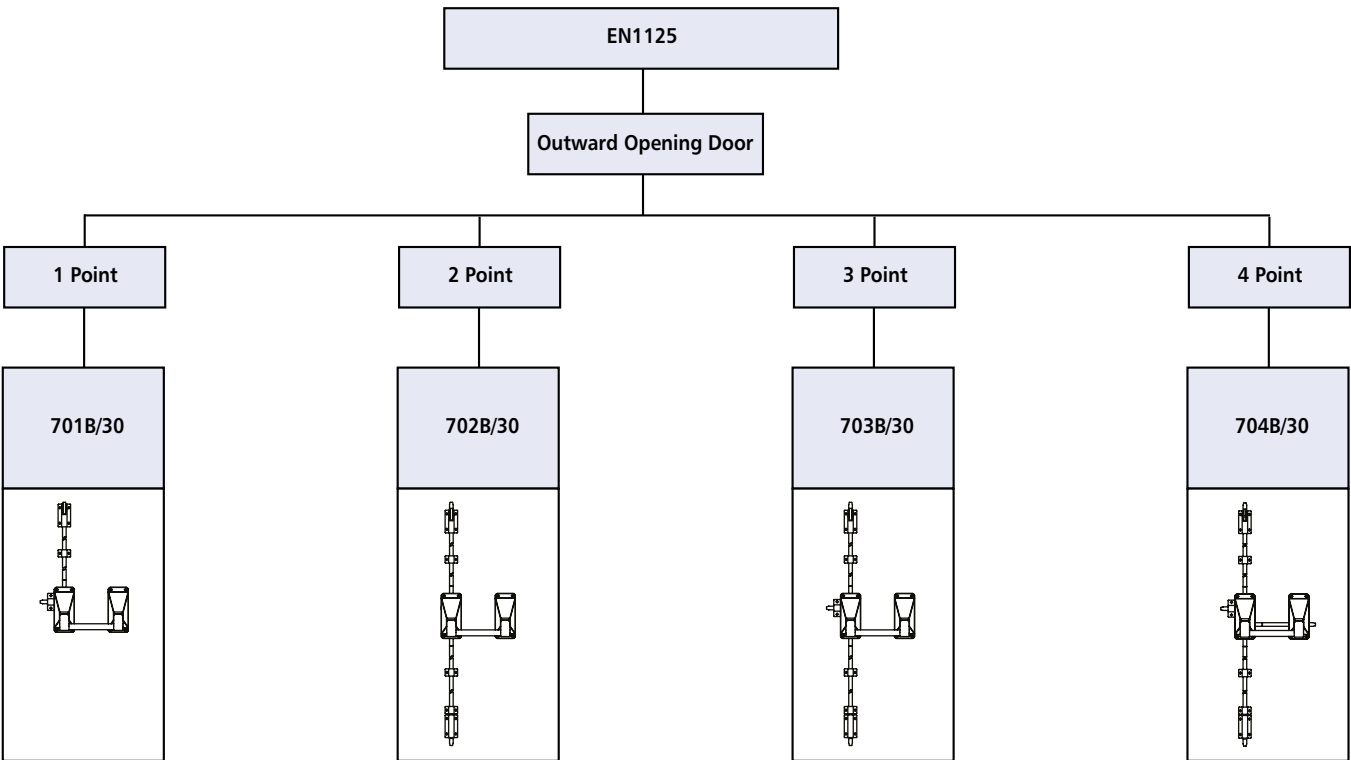

TIMBER & STEEL DOOR KEEPS

Latch Bolt and 4th Point Side Keeps

P6102 Standard Latch / Hinge Bolt Keep

- Supplied as standard with the 701L/30, 703L/30, 704L/30, 704BD/30, 701B/30, 703B/30, 704B/30, 713L/30 and 714L/30

Construction - mild steel | Finish - powder coated

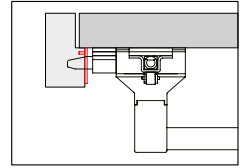
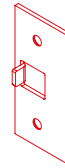

P6102

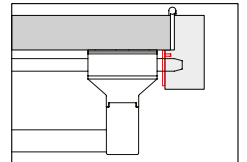
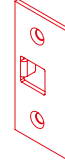

PHS006 Double Door Keep

- Supplied as standard with the 701BD/30, 703BD/30, 742BD/30, 743BD/30, 704BD/30 and 733L/30

Construction - mild steel | Finish - powder coated

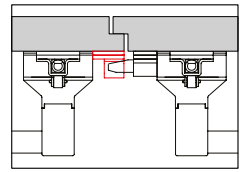
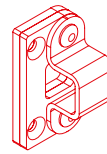

PHS006

Top Bolt Keeps

P6104 Standard Top Trip Keep

- Supplied as standard with the 702L/30, 703L/30, 704L/30, 702B/30, 703B/30, 704B/30, 701BD/30, 702BD/30, 703BD/30, 742BD/30, 743BD/30, 704BD/30, 712L/30, 713L/30 and 714L/30

Construction - mild steel | Finish - powder coated

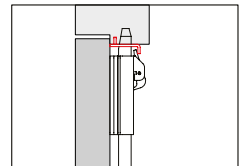
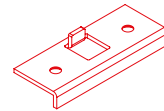

P6104

P6146 Standard Top Trip Plate for Single Point Devices

- Supplied as standard with the 701L/30, 701B/30 and 701BD/30
- No clearance hole in the frame is required

Construction - mild steel | Finish - powder coated

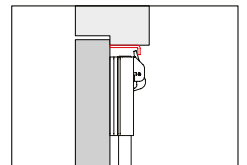
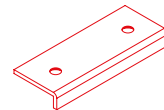

P6146

Bottom Bolt Keeps

P6102 Standard Flat Bottom Keep

- Supplied as standard with the 702L/30, 732L/30, 703L/30, 733L/30, 704L/30, 702B/30, 703B/30, 704B/30, 701BD/30, 702BD/30, 703BD/30, 704BD/30, 742BD/30, 743BD/30, 712L/30, 713L/30 and 714L/30

Construction - mild steel | Finish - powder coated

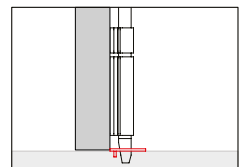
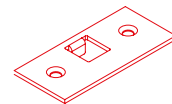

P6102

P0301 Easy Clean Floor Socket

Construction - cast iron | Finish - zinc plated

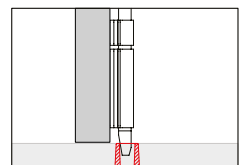
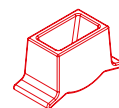

P0301

3405 Surface Mounted Bottom Keep

- Surface mounted keep for bottom shoot bolts
- No clearance hole in the floor is required

Construction - diecast zinc alloy | Finish - zinc plated

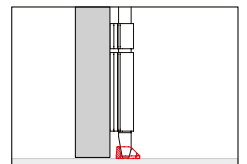

3405

Technical Data

Maintenance

It is important that all heavy duty high security locks, bolts and panic and emergency exit hardware devices are inspected and maintained properly to maintain performance and ensure safety when exiting a building in any situation.

Once the device is fitted regular maintenance is recommended.

Weekly:

- Make sure the exit device functions correctly
- Any fixings that have worked loose should be re-secured
- Any damaged components should be replaced
- Ensure there are no obstructions which prevent the panic emergency exit unit from functioning correctly

Every three months:

- Check for wear. Any visible worn components should be replaced

Fixing / Installation

Installation instructions are supplied with all the Exidor heavy duty high security locks, bolts and panic and emergency exit hardware. Provided the instructions are followed and the units are fitted by a competent person, the Exidor range will offer a high degree of safety and security. **No responsibility can be accepted by the manufacturer if the installation instructions are not followed.**

In order to meet the CEN European standards the door and frame should be of good quality and suitable to support the hardware.

Make sure that any weather strips or fixings on the door or frame do not interfere with the opening and closing of the door.

All bars and shoot bolts should be cut to the exact size on site and each is supplied with loose end plugs. Unless specified the Exidor range is supplied with all the necessary fixings for timber or steel frames and doors. However, for alternative fixings, please contact the manufacturer or your supplier.

Construction

The main body and slave units are constructed from a mixture of steel and stainless steel. The internal components are manufactured from steel and shoot ends are of solid steel with tubular steel rods.

Standard Sizes

Standard sized units are suitable for doors up to 1220mm wide and 2440mm high. The shoot bolts and cross bars can be cut down on site to suit the door height and width.

For larger doors above 2440mm high special size top shoot bolt lengths are available up on request. The following lengths are stocked by Exidor Ltd.

- 1210mm for doors up to 2440mm high (Standard size supplied)
- 1600mm for doors up to 2680mm high
- 2100mm for doors up to 3180mm high

Handing

The following diagrams identify if you require a left handed or right handed product, where applicable:

SINGLE DOORS OUTWARD OPENING

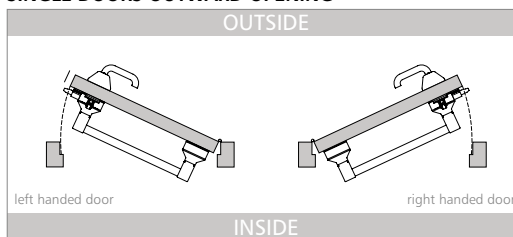

SINGLE DOORS INWARD OPENING

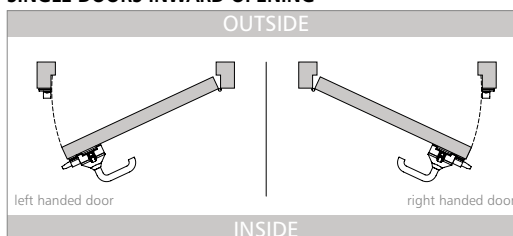

DOUBLE DOORS OUTWARD OPENING

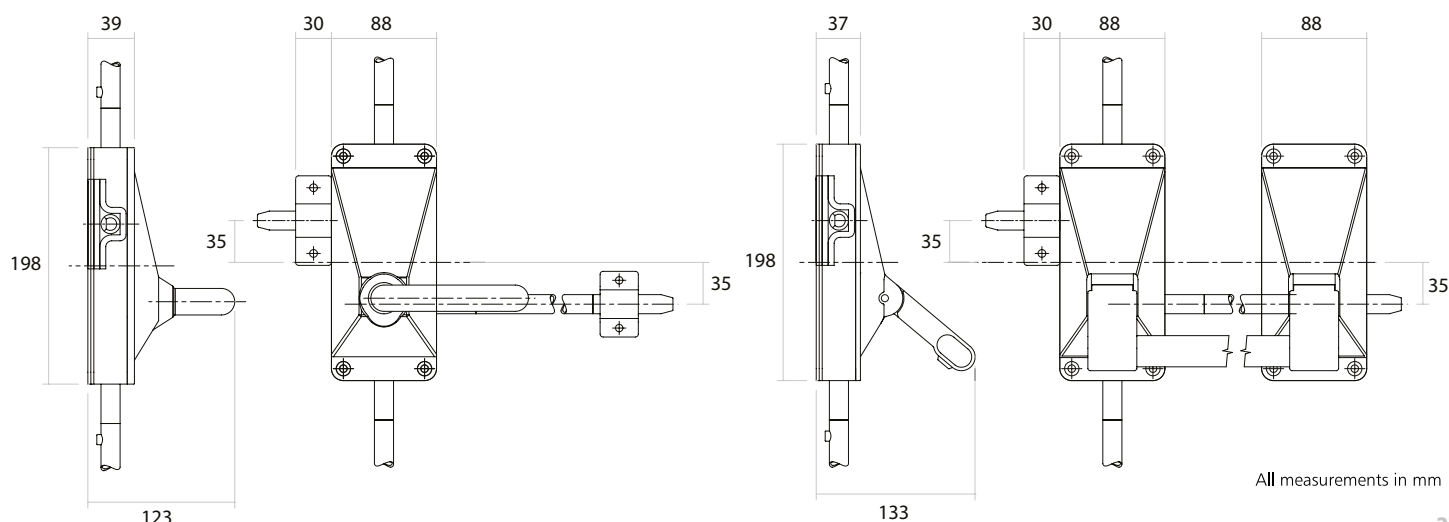
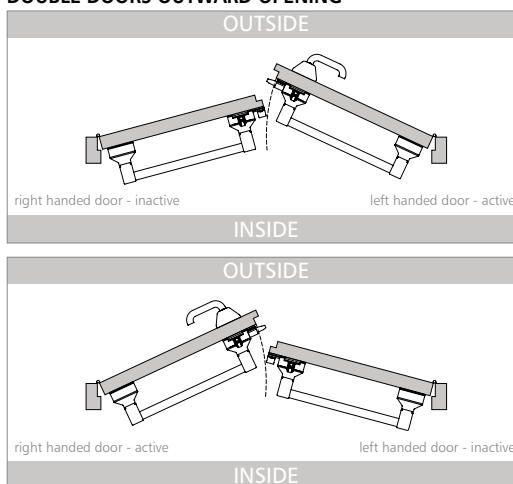

All measurements in mm

Product Features

Single doors

Product No.	Description	EN Standard		Door Type (opening)		CE Mark	Fire Rated	Steel Door Fixings	Timber Door Fixings	Deadlocking Function	Locking Points
		179	1125	Inward	Outward						
701B/30T	Push bar single panic latch		●		●	●	●		●		1
701B/30S	Push bar single panic latch		●		●	●	●	●			1
701L/30T	Lever operated single emergency exit latch	●			●	●	●		●		1
701L/30S	Lever operated single emergency exit latch	●			●	●	●	●			1
702B/30T	Push bar single panic bolt		●		●	●	●		●		2
702B/30S	Push bar single panic bolt		●		●	●	●	●			2
702L/30T	Lever operated single emergency exit bolt	●			●	●	●		●		2
702L/30S	Lever operated single emergency exit bolt	●			●	●	●	●			2
732L/30T	Lever operated single emergency exit bolt	●		●		●	●		●		2
732L/30S	Lever operated single emergency exit bolt	●		●		●	●	●			2
703B/30T	Push bar three point panic bolt		●		●	●	●		●		3
703B/30S	Push bar three point panic bolt		●		●	●	●	●			3
703L/30T	Lever operated three point emergency exit bolt	●			●	●	●		●		3
703L/30S	Lever operated three point emergency exit bolt	●			●	●	●	●			3
733L/30T	Lever operated three point emergency exit bolt	●		●		●	●		●		3
733L/30S	Lever operated three point emergency exit bolt	●		●		●	●	●			3
704B/30T	Push bar four point panic bolt		●		●	●	●		●		4
704B/30S	Push bar four point panic bolt		●		●	●	●	●			4
704L/30T	Lever operated four point emergency exit bolt	●			●	●	●		●		4
704L/30S	Lever operated four point emergency exit bolt	●			●	●	●	●			4
712L/30T	Lever operated high security two point multi-bolt				●				●	●	2
712L/30S	Lever operated high security two point multi-bolt				●			●		●	2
713L/30T	Lever operated high security three point multi-bolt				●				●	●	3
713L/30S	Lever operated high security three point multi-bolt				●			●		●	3
714L/30T	Lever operated high security four point multi-bolt				●				●	●	4
714L/30S	Lever operated high security four point multi-bolt				●			●		●	4

Double Doors

Product No.	Description	EN Standard		Door Type (opening)		CE Mark	Fire Rated	Steel Door Fixings	Timber Door Fixings	Deadlocking Function	Locking Points
		179	1125	Inward	Outward						
701BD/30T	Three Point Locking double door set		●		●	●	●		●		3
701BD/30S	Three Point Locking double door set		●		●	●	●	●			3
742BD/30T	Four point locking CE marked double door set		●		●	●	●		●		4
742BD/30S	Four point locking CE marked double door set		●		●	●	●	●			4
702BD/30T	Four point locking double door set				●				●		4
702BD/30S	Four point locking double door set				●			●			4
743BD/30T	Five point locking CE marked double door set		●		●	●	●		●		5
743BD/30S	Five point locking CE marked double door set		●		●	●	●	●			5
703BD/30T	Five point locking double door set				●				●		5
703BD/30S	Five point locking double door set				●			●			5
704BD/30T	Seven point locking double door set				●				●		7
704BD/30S	Seven point locking double door set				●			●			7

Find It Fast!

You don't need to trawl through catalogues any more. Just use the product specifiers on our new website to take you straight to the specific product you want.

exidor.co.uk

