

# GEZE INSTALLATION OPTIONS

## RECOMMENDED SETTINGS FOR GEZE DOOR CLOSERS

► Remove slide plate

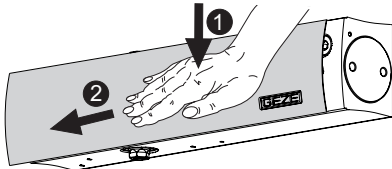

► Clip slide plate open

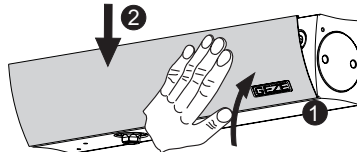

► Set

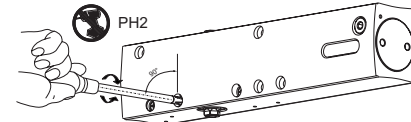

### GEZE TS 5000

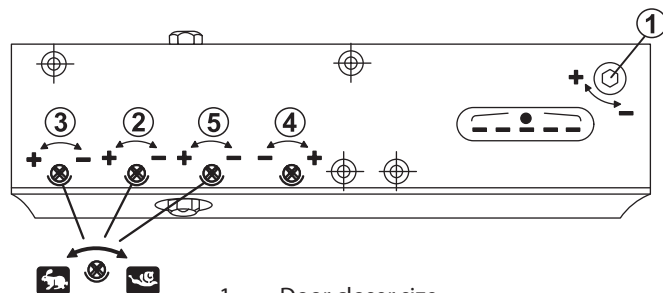

- 1 Door closer size
- 2 Closing speed
- 3 Latching action
- 4 Back check
- 5 Delayed closing action (only with TS 5000 S)

Display door closer size	Leaf width [mm]
2	up to 850
3	850 - 950
4	950 - 1100
5	1100 - 1250
6	1250 - 1400

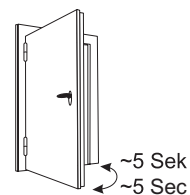

Light-running door must be closed completely by the closer!

### GEZE TS 4000

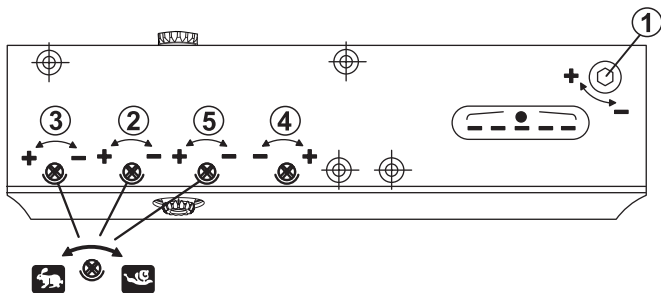

- 1 Door closer size
- 2 Closing speed
- 3 Latching action (only with TS 4000 S)
- 4 Back check
- 5 Delayed closing action (only with TS 4000 S)

Display door closer size	Leaf width [mm]
1	up to 750
2	750 - 850
3	850 - 950
4	950 - 1100
5	1100 - 1250
6	1250 - 1400

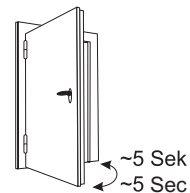

Light-running door must be closed completely by the closer!

Setting latching action	with latching action	without latching action
-------------------------	----------------------	-------------------------

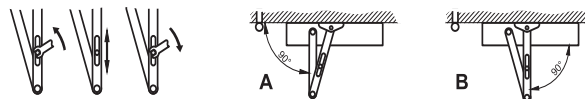

## GEZE INSTALLATION OPTIONS

## GEZE TS 3000 V

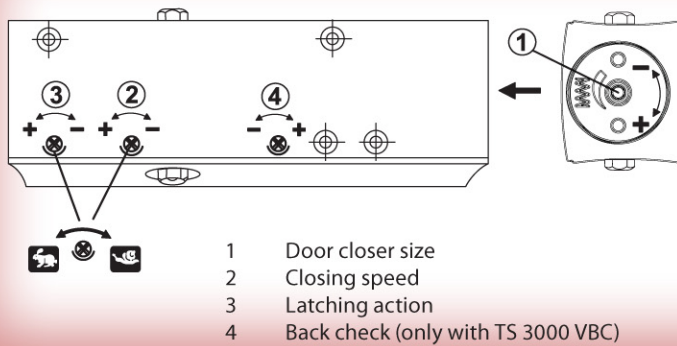

Setting door closer size	Leaf width [mm]
Buffer -	up to 750
2.5 revolutions	750 - 850
5 revolutions	850 - 950
Buffer +	950 - 1100

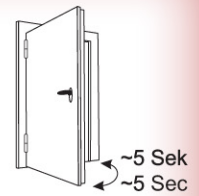

Light-running door must be closed completely by the closer!

## GEZE TS 2000 V

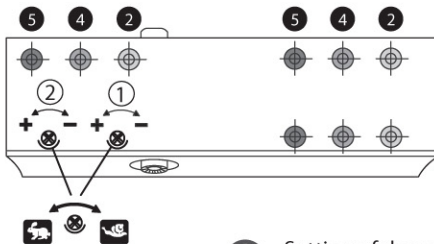

! Setting of door closer size through offset installation

Setting door closer size	Leaf width [mm]
2 Size 2	750 - 850
4 Size 4	850 - 1100
5 Size 5	1100 - 1250

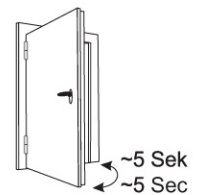

Light-running door must be closed completely by the closer!

Setting latching action	with latching action	without latching action

## GEZE TS 2000 NV

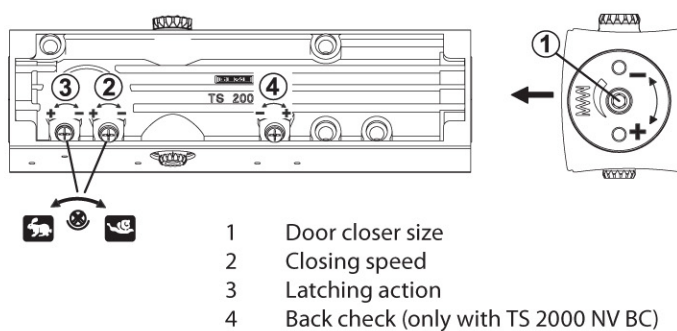

Setting door closer size	Leaf width [mm]
Buffer -	up to 850
4 revolutions	850 - 950
Buffer +	up to 1100

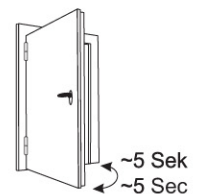

Light-running door must be closed completely by the closer!

## GEZE TS 1500

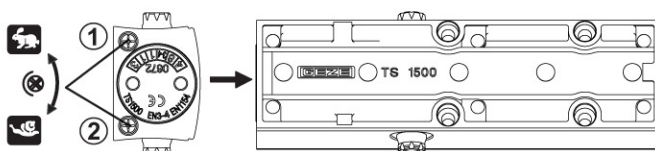

! Setting of door closer size by turning the top of the link arm

Setting door closer size	Leaf width [mm]
	850 - 950
	950 - 1100

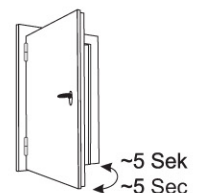

Light-running door must be closed completely by the closer!

# GEZE INSTALLATION OPTIONS

## General product information about GEZE overhead door closers

### Door closer sizes

acc. to EN 1154	Door leaf width in mm
Size 1	up to 750
Size 2	from 750 to 850
Size 3	from 850 to 950
Size 4	from 950 to 1100
Size 5	from 1100 to 1250
Size 6	from 1250 to 1400
Size 7	from 1400 to 1600

### Notes for door closers with guide rail for installation on the opposite hinge side

Note: The max. door opening angle must be limited by a door stopper or by use of the GEZE T-Stop guide rail!

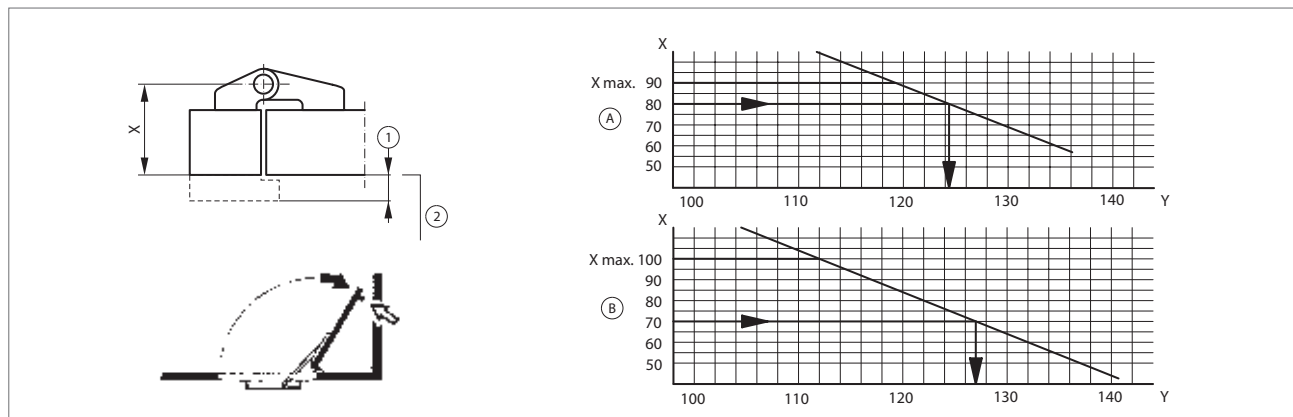

1 = Overlap max. 15 mm

2 = Flush-mounted door

X = Distance pivot point to contact area of guide rail

X dimension max. = 100 mm (double-leaf) / 90 mm (single-leaf)

A = Single-leaf systems

B = Double-leaf systems

Y = Door opening angle

Special mounting dimensions are used when the X dimension is wider – on request.

### Notes for door closers with link arm for installation on the opposite hinge side

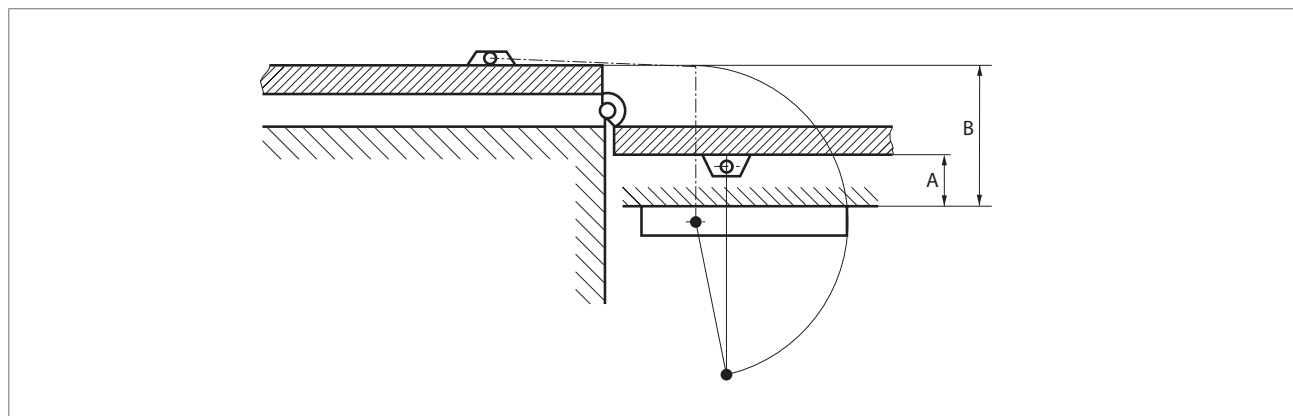

A = Reveal depth

B = Reveal depth + 2 door size + 2 pivot point distance

Door opening up to 180° is only possible if the following dimensions are not exceeded:

A = 70 mm and B = 200 mm

## GEZE TS 3000 V / V BC / EN3

## Door leaf installation hinge side

TS 3000 V Door leaf installation/hinge side

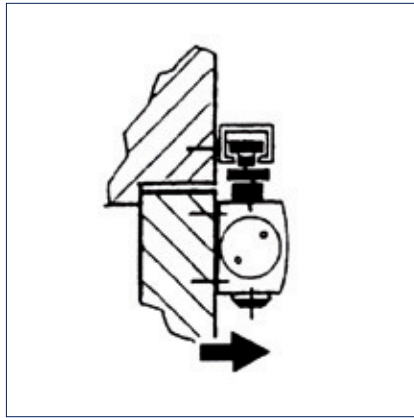
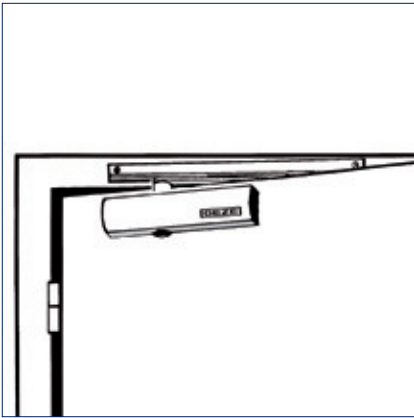

## Area of application

- Closing force 1-4 according to EN 1154, leaf width up to 1100 mm
- Can be used for right and left hung doors without conversion
- For fireproof doors (door closer with mounting plate)
- GEZE TS 3000 EN3 for leaf widths up to 950 mm

## Order information

Description	Version	ID.No.
GEZE TS 3000 V Closer Size EN 1-4 (without guide rail and lever)	silver	028348
GEZE TS 3000 EN3 Closer Size EN 3 (without guide rail and lever)	silver	102247
GEZE TS 3000 V BC Closer Size EN 1-4, with back check (without guide rail and lever)	silver	109326
Guide rail TS 5000/TS 3000 Standard, with lever	silver	068221
<b>Accessories</b>		
Mechanical hold-open unit for Standard / T-Stop / Boxer 20.7 mm guide rail, adjustable holding force, can be switched on and off, can be overridden		071924
Guide rail mounting plate for standard / Ecline / T-Stop / EFS guide rail	silver	001512
Mounting plate door closer for TS 3000 with hole pattern according to DIN EN 1154 Supplement 1	silver	011230

Note: See our system catalogues for further accessories and colour variants.

## GEZE INSTALLATION OPTIONS

### GEZE TS 3000 V / V BC / EN3

#### Door leaf installation opposite hinge side

TS 3000 V Door leaf installation/opposite hinge side

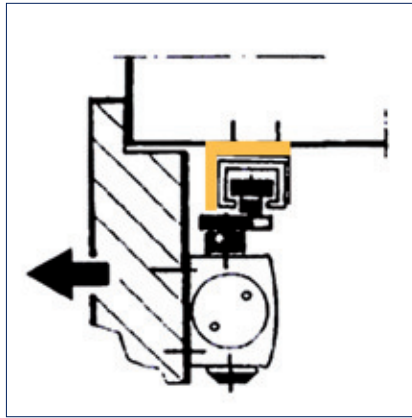

#### Area of application

- Closing force 1-4 according to EN 1154, leaf width up to 1100 mm
- Can be used for right and left hung doors without conversion
- For fire protection doors (door closer with mounting plate)
- GEZE TS 3000 EN3 for leaf widths up to 950 mm
- Installation with lintel casing bracket possible

#### Order information

Description	Version	ID.No.
GEZE TS 3000 V Closer Size EN 1-4 (without guide rail and lever)	silver	028348
GEZE TS 3000 EN3 Closer Size EN 3 (without guide rail and lever)	silver	102247
GEZE TS 3000 V BC Closer Size EN 1-4, with back check (without guide rail and lever)	silver	109326
Guide rail BG TS 5000/TS 3000 Standard, with lever, use with closer on leaf installation on the opposite hinge side	silver	025655
<b>Accessories</b>		
Mechanical hold-open unit for Standard / T-Stop / Boxer 20.7 mm guide rail, adjustable holding force, can be switched on and off, can be overridden		071924
Mounting plate guide rail BG for standard / Ecline / T-Stop / EFS guide rail	silver	124683
Mounting plate door closer for TS 3000 with hole pattern according to DIN EN 1154 Supplement 1	silver	011230
Lintel casing bracket guide rail BG for standard guide rail	silver	025657

Note: See our system catalogues for further accessories and colour variants.

## GEZE TS 3000 V / V BC / EN3

## Door leaf installation hinge side with mounting and counterplate for all-glass door

TS 3000 V Door leaf installation/hinge side counterplate glass

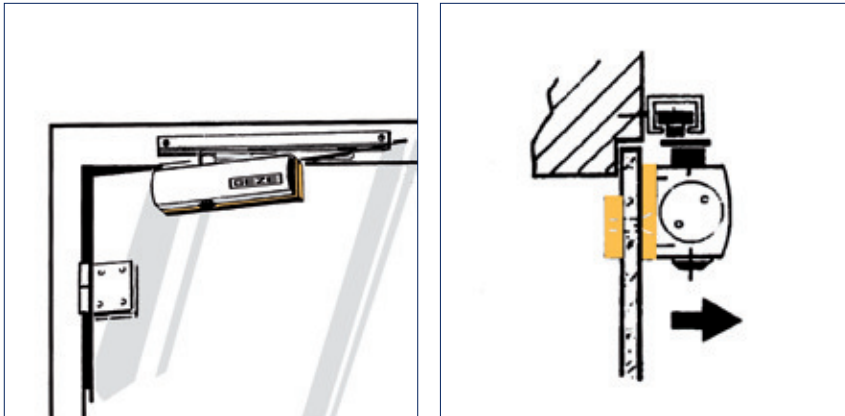

## Area of application

- Closing force 1-4 according to EN 1154, leaf width up to 1100 mm
- Can be used for right and left hung doors without conversion
- GEZE TS 3000 EN3 for leaf widths up to 950 mm
- Mounting and counterplate, glass thickness 10 / 12 mm
- See the corresponding installation/assembly drawing for the preparation dimensions

## Order information

Description	Version	ID.No.
GEZE TS 3000 V Closer Size EN 1-4 (without guide rail and lever)	silver	028348
GEZE TS 3000 EN3 Closer Size EN 3 (without guide rail and lever)	silver	102247
GEZE TS 3000 V BC Closer Size EN 1-4, with back check (without guide rail and lever)	silver	109326
Guide rail TS 5000/TS 3000 Standard, with lever	silver	068221
<b>Accessories</b>		
Mounting and counterplate for all-glass door for TS 3000/TS 2000 NV	silver	090259
Mechanical hold-open unit for Standard / T-Stop / Boxer 20.7 mm guide rail, adjustable holding force, can be switched on and off, can be overridden		071924
Guide rail mounting plate for standard / Ecline / T-Stop / EFS guide rail	silver	001512

Note: See our system catalogues for further accessories and colour variants.

## GEZE INSTALLATION OPTIONS

### GEZE TS 3000 V / V BC / EN3

#### Door leaf installation hinge side with clamping shoe for all-glass door

TS 3000 V Door leaf installation/hinge side clamping shoe glass

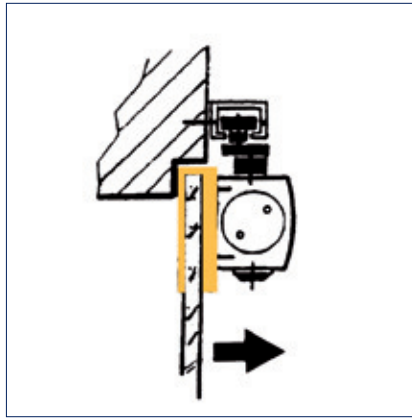
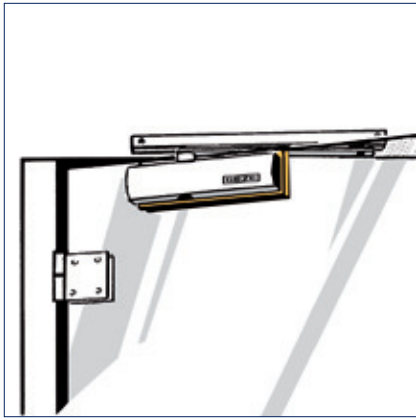

#### Area of application

- Closing force 1-4 according to EN 1154, leaf width up to 1100 mm
- Can be used for right and left hung doors without conversion
- GEZE TS 3000 EN3 for leaf widths up to 950 mm
- Clamping shoe, glass thickness 8-10 mm

#### Order information

Description	Version	ID.No.
GEZE TS 3000 V Closer Size EN 1-4 (without guide rail and lever)	silver	028348
GEZE TS 3000 EN3 Closer Size EN 3 (without guide rail and lever)	silver	102247
GEZE TS 3000 V BC Closer Size EN 1-4, with back check (without guide rail and lever)	silver	109326
Guide rail TS 5000/TS 3000 Standard, with lever	silver	068221
<b>Accessories</b>		
Glass clamping shoe door closer for TS 3000/TS 2000 NV	silver	014835
Mechanical hold-open unit for Standard / T-Stop / Boxer 20.7 mm guide rail, adjustable holding force, can be switched on and off, can be overridden		071924
Guide rail mounting plate for Standard / Ecline / T-Stop / EFS guide rail	silver	001512

Note: See our system catalogues for further accessories and colour variants.

## GEZE TS 3000 V / V BC / EN3

## Transom installation hinge side

TS 3000 V Transom installation/hinge side

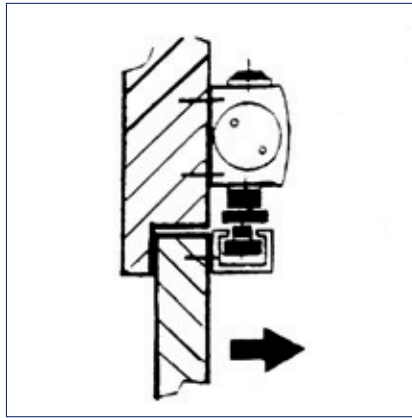
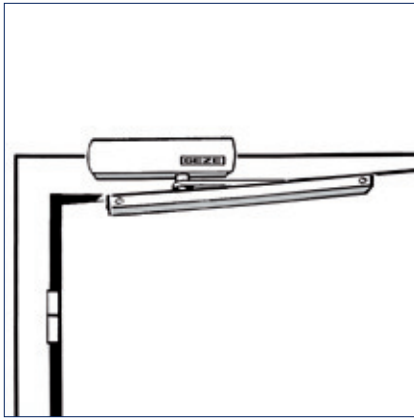

## Area of application

- Closing force 1-4 according to EN 1154, leaf width up to 1100 mm
- Can be used for right and left hung doors without conversion
- GEZE TS 3000 EN3 for leaf widths up to 950 mm
- For fire protection doors with respective suitability certificate

## Order information

Description	Version	ID.No.
GEZE TS 3000 V Closer Size EN 1-4 (without guide rail and lever)	silver	028348
GEZE TS 3000 EN3 Closer Size EN 3 (without guide rail and lever)	silver	102247
GEZE TS 3000 V BC Closer Size EN 1-4, with back check (without guide rail and lever)	silver	109326
Guide rail TS 5000/TS 3000 Standard, with lever	silver	068221
<b>Accessories</b>		
Mechanical hold-open unit for Standard / T-Stop / Boxer 20.7 mm guide rail, adjustable holding force, can be switched on and off, can be overridden		071924
Guide rail mounting plate for Standard / ECLine / T-Stop / EFS guide rail	silver	001512
Mounting plate door closer for TS 3000 with hole pattern according to DIN EN 1154 Supplement 1	silver	011230

Note: See our system catalogues for further accessories and colour variants.



## GEZE INSTALLATION OPTIONS

### GEZE TS 3000 V / V BC / EN3

#### Transom installation opposite hinge side

TS 3000 V Transom installation/opposite hinge side

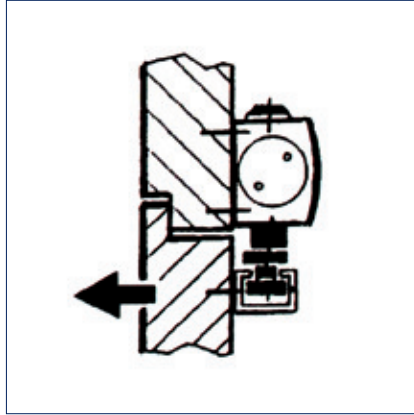
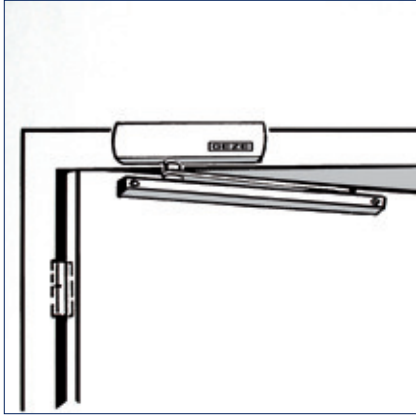

#### Area of application

- Closing force 1-4 according to EN 1154, leaf width up to 1100 mm
- Can be used for right and left hung doors without conversion
- GEZE TS 3000 EN3 for leaf widths up to 950 mm
- For fire protection doors with respective suitability certificate

#### Order information

Description	Version	ID.No.
GEZE TS 3000 V Closer Size EN 1-4 (without guide rail and lever)	silver	028348
GEZE TS 3000 EN3 Closer Size EN 3 (without guide rail and lever)	silver	102247
GEZE TS 3000 V BC Closer Size EN 1-4, with back check (without guide rail and lever)	silver	109326
Guide rail TS 5000/TS 3000 Standard, with lever	silver	068221
Guide rail TS 5000/3000, riveted fixed riveted slider with lever	silver	069650
<b>Accessories</b>		
Mechanical hold-open unit for Standard / T-Stop / Boxer 20.7 mm guide rail, adjustable holding force, can be switched on and off, can be overridden		071924
Guide rail mounting plate for Standard / Ecline / T-Stop / EFS guide rail	silver	001512
Mounting plate door closer for TS 3000 with hole pattern according to DIN EN 1154 Supplement 1	silver	011230

Note: See our system catalogues for further accessories and colour variants.

## GEZE TS 3000 V / V BC / EN3

### Transom installation opposite hinge side with lintel casing bracket

TS 3000 V Transom installation/opposite hinge side lintel casing bracket

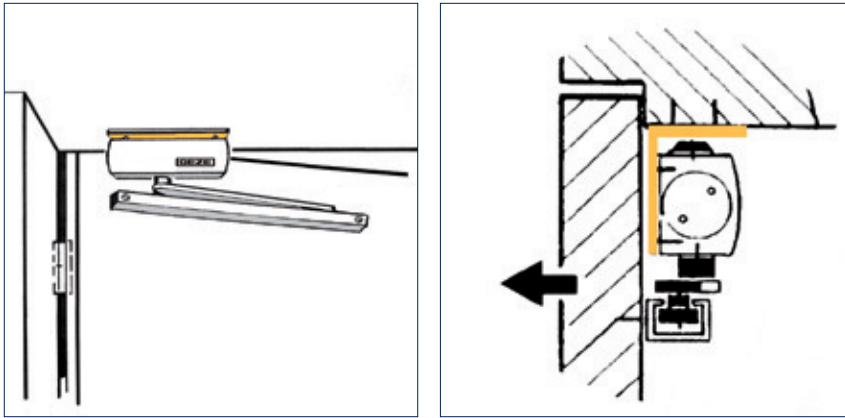

#### Area of application

- Closing force 1-4 according to EN 1154, leaf width up to 1100 mm
- Can be used for right and left hung doors without conversion
- GEZE TS 3000 EN3 for leaf widths up to 950 mm
- Note for emergency exit routes, restriction of passage height by approx. 100 mm
- For fire protection doors with respective suitability certificate

#### Order information

Description	Version	ID.No.
GEZE TS 3000 V Closer Size EN 1-4 (without guide rail and lever)	silver	028348
GEZE TS 3000 EN3 Closer Size EN 3 (without guide rail and lever)	silver	102247
GEZE TS 3000 V BC Closer Size EN 1-4, with back check (without guide rail and lever)	silver	109326
Guide rail TS 5000/TS 3000 Standard, with lever	silver	068221
Guide rail TS 5000/3000, riveted fixed riveted slider, with lever	silver	069650
<b>Accessories</b>		
Mechanical hold-open unit for Standard / T-Stop / Boxer 20.7 mm guide rail, adjustable holding force, can be switched on and off, can be overridden		071924
Guide rail mounting plate for Standard / Ecline / T-Stop / EFS guide rail	silver	001512
Lintel casing bracket transom installation BG for TS 2000 NV / TS 3000 V	silver	127432

Note: See our system catalogues for further accessories and colour variants.